

Saliva Tracer

Oral Fluid Drug Screen Test Procedure Card



1



Bring the pouch to room temperature before opening. Remove the test from the sealed pouch and use within one hour of opening. Instruct the donor to place the tongue against the root of the upper or lower jaw and collect saliva in the mouth.

2

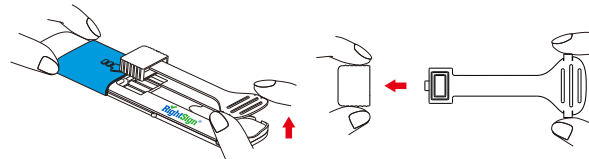

Remove the swab from the cassette, then remove the cap from the swab.

3

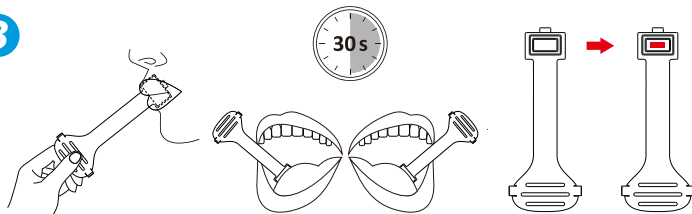

Note: If the saturation indicator has not turned red, place the swab back in the mouth and continue to collect saliva until the saturation indicator turns red.

Instruct the donor to place the swab between the lower cheek and gum and gently rub back and forth between the left and right cheeks and gums until the sponge is completely saturated with saliva. Do not bite, suck, or chew the sponge as it may break. **Remove the swab from the mouth after 30 seconds**, if the saturation indicator has turned red.

4

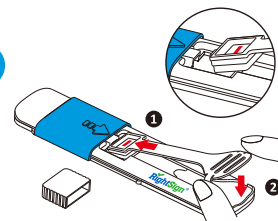

Insert the swab into the cassette.

Note: When inserting the swab into the cassette, insert the protruding part of the swab head into the hole reserved at the sampling site, and then press down the tail of the swab to secure it.

5

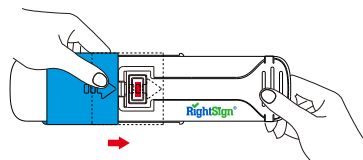

Slide the cover in the direction of the arrow until the cover is blocked.

6

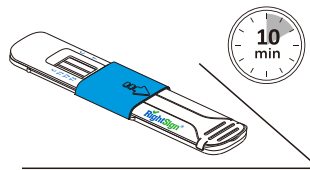

Place the device on a flat surface while the test is running. Negative results can be read as soon as clear lines form in both the C and T zones of the test. Read presumptive positive results at 10 minutes. Do not read results after 20 minutes.

